

Conveyor chains

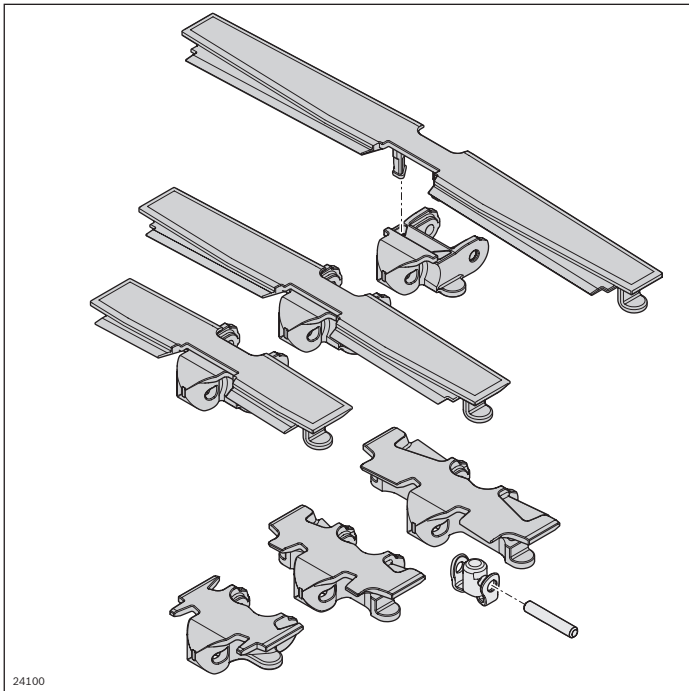

- ▶ Quiet and smooth-running parts transport thanks to patented conveyor chains
- ▶ Optimized antifriction properties of the chains
- ▶ Chain links uncoupled by means of different materials (patented)
- ▶ FDA-compliant materials
- ▶ Low-vibration transport of small parts and accumulation option by covering the chain links
- ▶ Easy-to-exchange chain plate from size 160
- ▶ Wide variety of chain types suitable for different applications

Flat conveyor chain

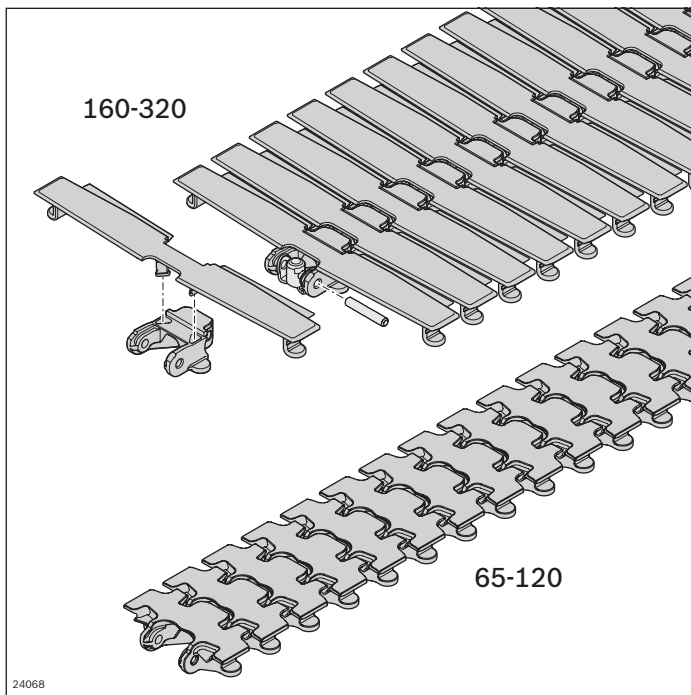

- Drilling the flat conveyor chain links allows for the simple attachment of superstructures. Sizes 65-120 have a mold cavity for accommodating a flat M5 hexagon nut. Sizes 160-320 have a centering aid mounted on the underside of the chain plate. Max. drilling up to $\varnothing 5$ mm, since at this point there are no interfering contours in the chain conveyor, see p. 21

Required accessories for individual chain links:

- Chain pin and pivot pin, see p. 19

For base chain links 160-320, a chain plate is also required, see p. 20, 21

Optional accessories:

- Static friction chain link, see p. 22
- Accumulation roller chain link D11, see p. 26
- Roller cleated chain link D20, see p. 30
- Cleated chain link, see p. 36
- Universal chain link, see p. 38

The flat conveyor chain is used to transport products directly or indirectly via workpiece pallets.

The gray conveyor chain is mainly used to transport products indirectly via workpiece pallets, in particular for steel wear pads. The dark coloring means that there is virtually no visual impairment of the chain surface.

- Transport on ascending or descending sections up to about 7° possible, depending on the product (test required)
- Accumulation operation permitted, depending on the product
- Maximum chain tensile force: 1250 N
- From size 160: Chain plate easy to replace
- Size gray chain: 65, 90
- Chain links can be combined with other types of chains of the same size
- Chain also available in ESD version, see conveyor chain ESD on page 190

- Extremely quiet chain running thanks to the patented chain design

- Materials meet the requirements of EU 10/2011 and FDA CFR 21 (does not apply for conveyor chain gray)

Scope of delivery:

- Chain: Complete, incl. chain pin and pivot pin

Condition on delivery:

- Chain: Fully assembled

Material:

- Chain link: POM
- Chain plate: POM
- Chain pin: Non-rusting steel 1.4301
- Pivot pin: PA66

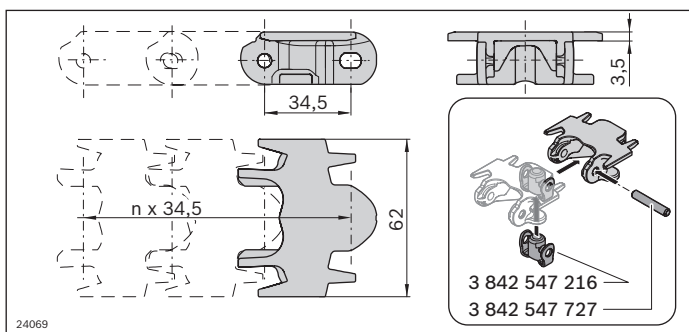

Flat conveyor chain VFplus 65	L (mm)	No.
Conveyor chain	4968	1 3 842 546 069
Chain link	10	3 842 546 000
Conveyor chain, gray	4968	1 3 842 546 075
Chain pin	100	3 842 547 727
Pivot pin	100	3 842 547 216

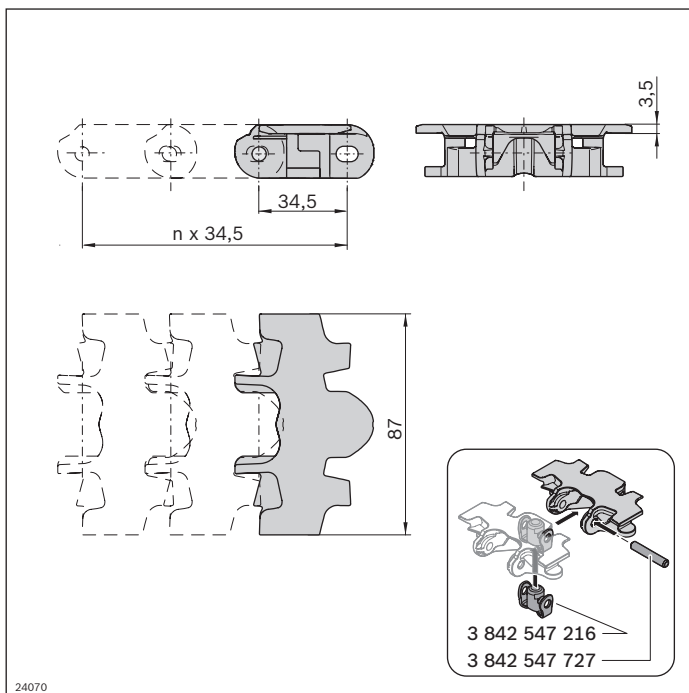

Flat conveyor chain VFplus 90	L (mm)	No.
Conveyor chain	4968	1 3 842 546 070
Chain link	10	3 842 546 001
Conveyor chain, gray	4968	1 3 842 546 076
Chain pin	100	3 842 547 727
Pivot pin	100	3 842 547 216

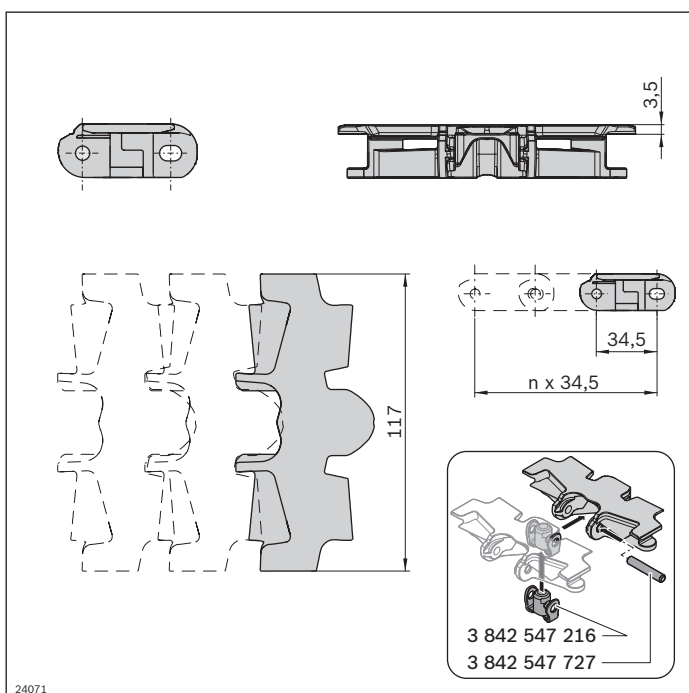

Flat conveyor chain VFplus 120	L (mm)	No.
Conveyor chain	4968	1 3 842 546 071
Chain link	10	3 842 546 002
Chain pin	100	3 842 547 727
Pivot pin	100	3 842 547 216

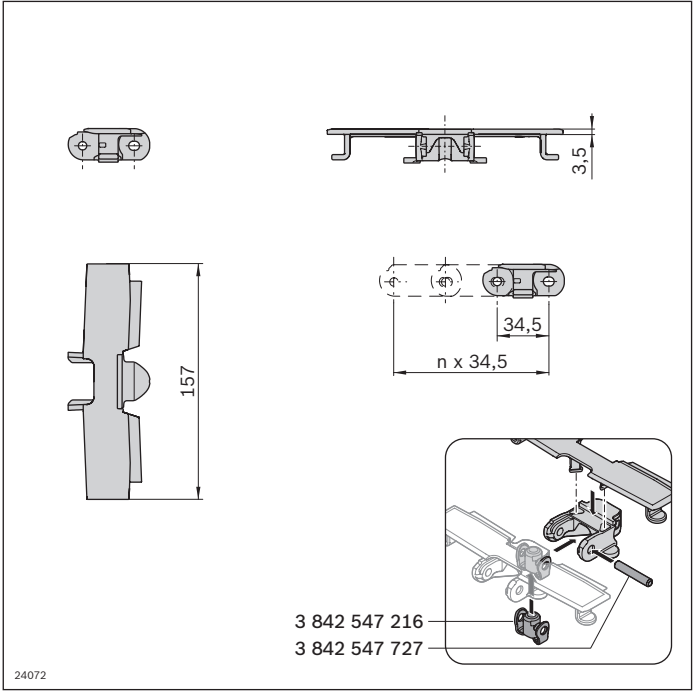

Flat conveyor chain VFplus 160	L (mm)		No.
Conveyor chain	2898	1	3 842 546 072
Basic chain link 160-320		10	3 842 546 028
Chain plate 160		10	3 842 546 093
Chain pin		100	3 842 547 727
Pivot pin		100	3 842 547 216

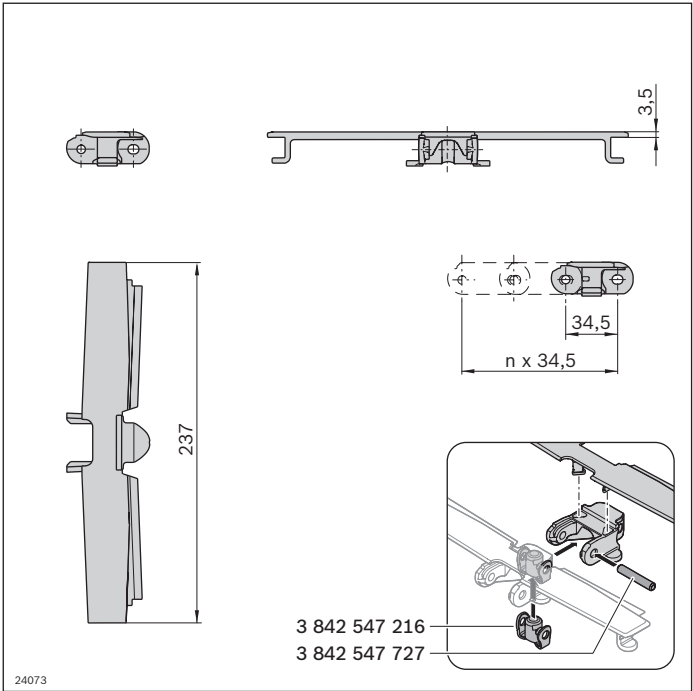

Flat conveyor chain VFplus 240	L (mm)		No.
Conveyor chain	2898	1	3 842 546 073
Basic chain link 160-320		10	3 842 546 028
Chain plate 240		10	3 842 546 094
Chain pin		100	3 842 547 727
Pivot pin		100	3 842 547 216

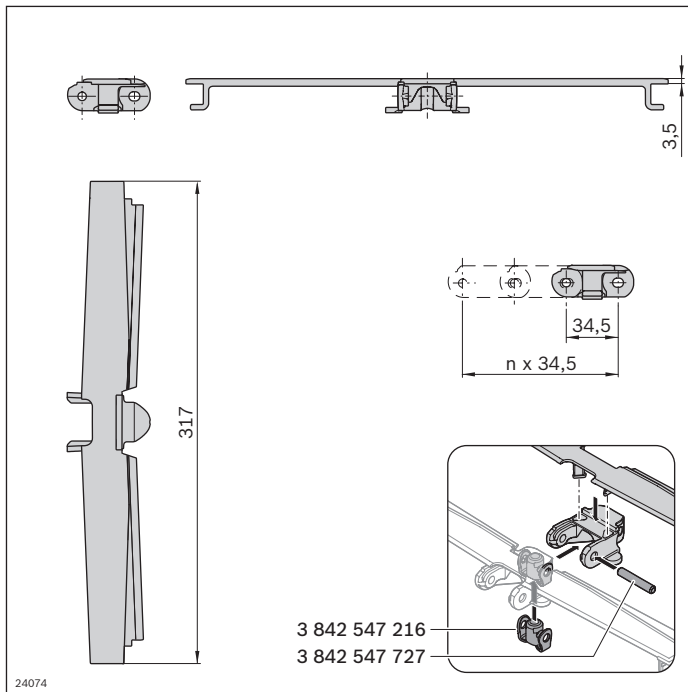

Flat conveyor chain VFplus 320	L (mm)	No.
Conveyor chain	2898	1 3 842 546 074
Basic chain link 160-320	10	3 842 546 028
Chain plate 320	10	3 842 546 095
Chain pin	100	3 842 547 727
Pivot pin	100	3 842 547 216

2

Notice for the attachment of structures

VFplus 160

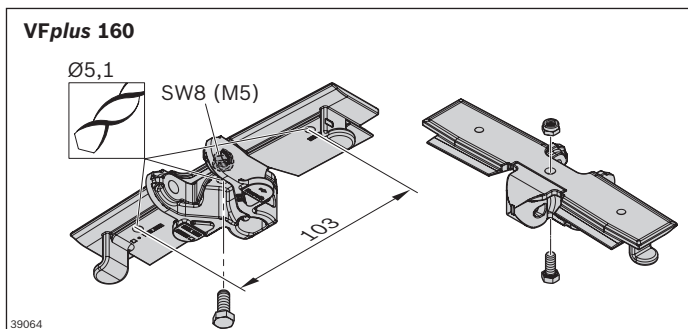

VFplus 240-320

Notice: Risk of collision! Only use the mounting points provided.

