

Workpiece pallet system (WT)

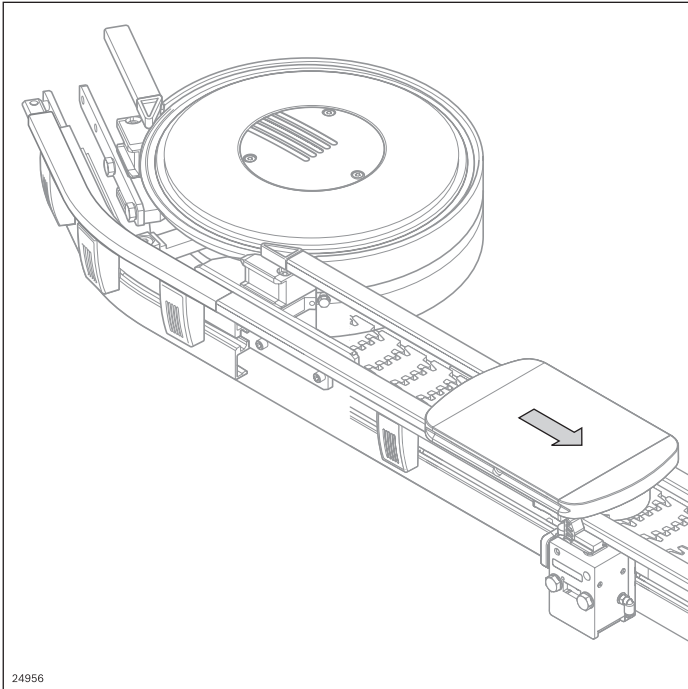

- ▶ Secure transport of parts thanks to the modular design with comprehensive additional components
- ▶ Numerous components for control WT such as diverter, stopper, positioning unit, etc.
- ▶ Selection of wear pads with different materials
- ▶ Compatible with the identification system ID 15

24956

VarioFlow workpiece pallet (WT)

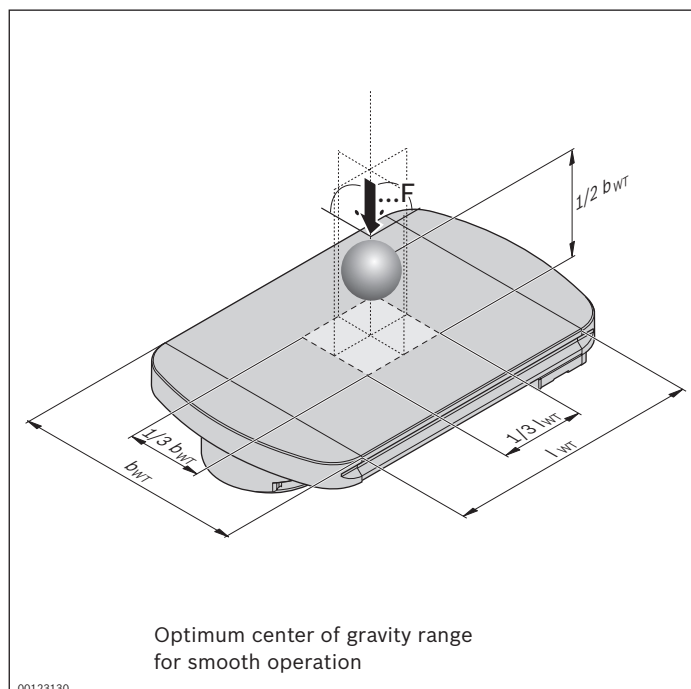
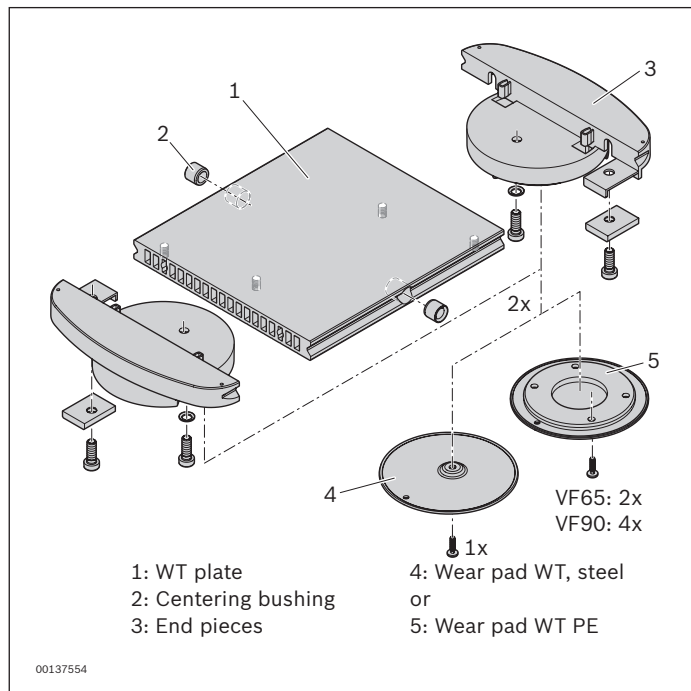

For transporting products that are not suitable for accumulation operation or are unstable due to their geometry

- Max. transport speed for operation with workpiece pallets: $v_N = 18 \text{ m/min}$
 - Wear pads WT either made of:
 - Steel, for use in harsh environments
 - PE, for use in clean environments
 - WT load (workpiece, support, etc.)
 - Size 65: 8 kg
 - Size 90: 8 kg
 - The modular concept allows for WT lengths of up to 500 mm*. With centering bushings for positioning in the positioning unit.
- * For WT with $L > 300 \text{ mm}$, combine 2 curve wheels 90° with intermediate section (min. 200 mm).
- Max. WT length (incl. end pieces) for 180° curve wheel:
- Size 65: 360 mm
 - Size 90: 410 mm
- Minimum length of the workpiece pallets:
 - Size 65: $L_{\min} = 76 \text{ mm}$
 - Size 90: $L_{\min} = 114 \text{ mm}$
 - Minimum length of the workpiece pallets in order to be positioned by the positioning unit (see p. 260):
 - Size 65: $L_{\min} = 125 \text{ mm}$
 - Size 90: $L_{\min} = 125 \text{ mm}$

Minimum length WT for passive bridge $L \geq 300$

- ▶ Level WT surfaces with no indentations
- ▶ The entire top of the WT can be built upon since everything else on the section is ready-mounted below the top of the WT.
- ▶ Compatible with the identification systems ID 15 and ID 200. Integrated installation of a mobile data tag is possible.
- ▶ The product can also protrude beyond the WT if the position of the center of gravity is taken into consideration.

Material:

- WT plate: Aluminum; natural, anodized
- End pieces: PA; black
- Workpiece pallet wear pads: Steel, stainless, $HV \geq 480$ or PE

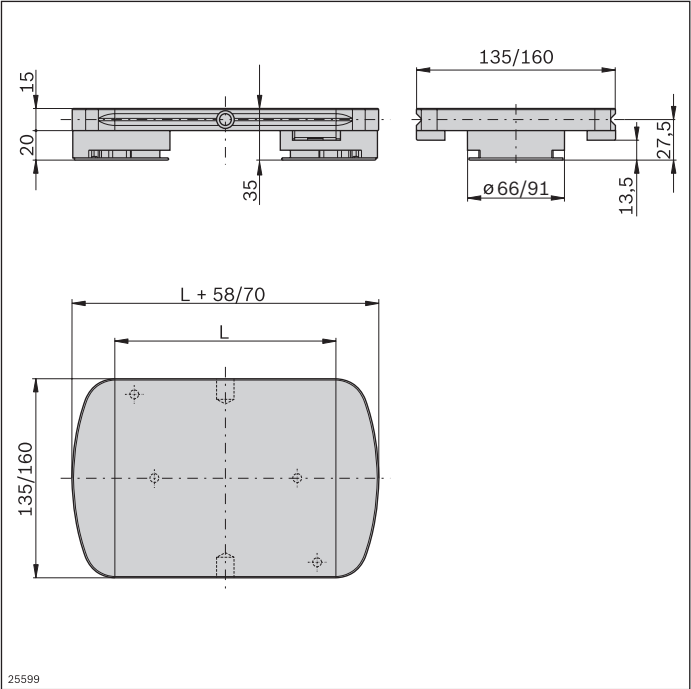

Workpiece pallet ¹⁾	L (mm)	No.
VFplus 65	150	1 3 842 541 888
VFplus 90	175	1 3 842 541 889

¹⁾ Mounted without wear pad, with positioning bushing

The mounted workpiece pallet must be provided with wear pads (steel or PE) by the customer.

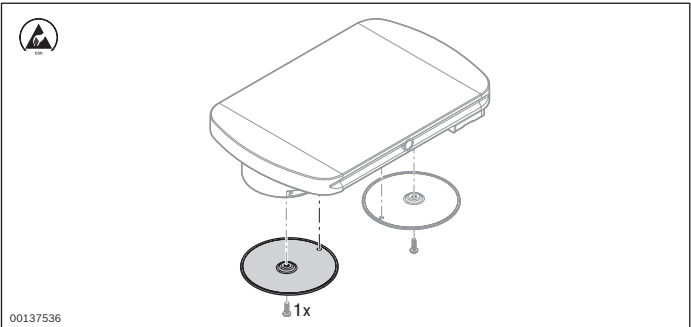

Steel wear pad	No.
VFplus 65	10 3 842 528 773
VFplus 90	10 3 842 528 772

Required accessories:

- Screw **3 842 543 246** (not in scope of delivery)

Notice: We recommend using the gray chain, see p. 19.

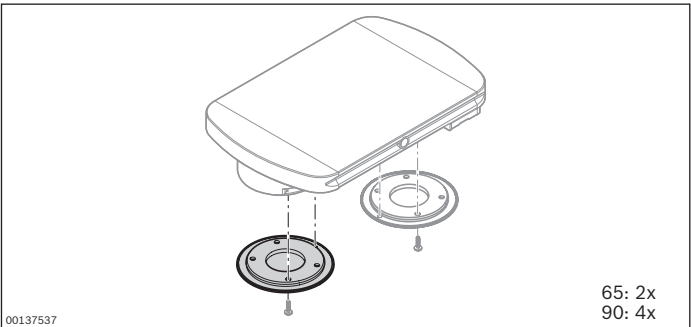

PE wear pad	No.
VFplus 65	10 3 842 541 566
VFplus 90	10 3 842 541 567

Required accessories:

- Screw **3 842 543 246** (not in scope of delivery)

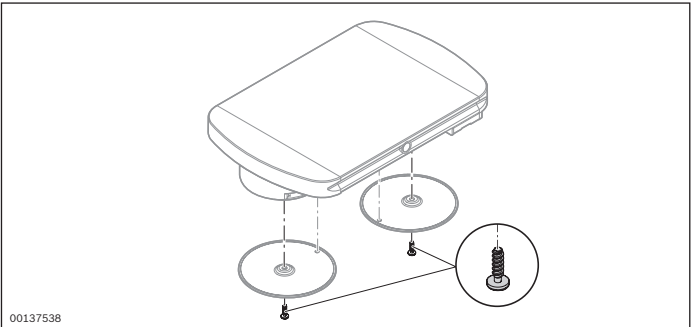

Screw	No.
	100 3 842 543 246