

Aluminum system (AL) VarioFlow *plus*

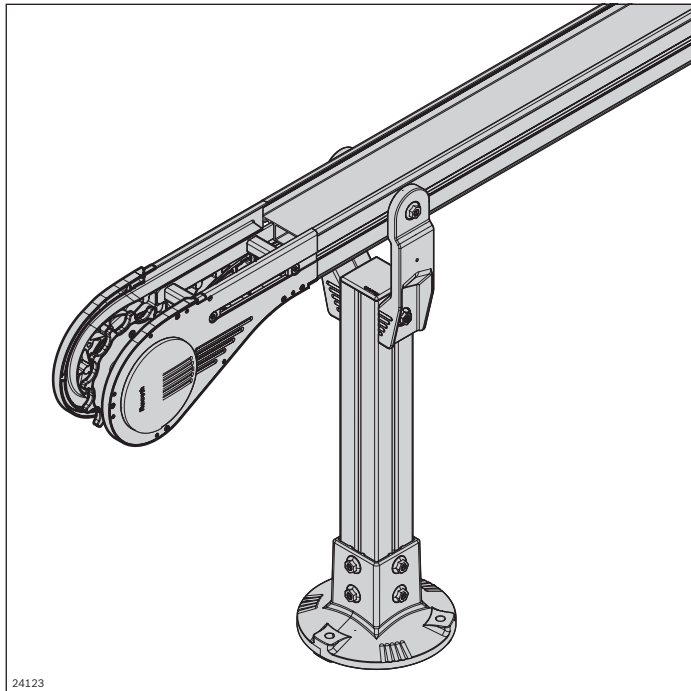

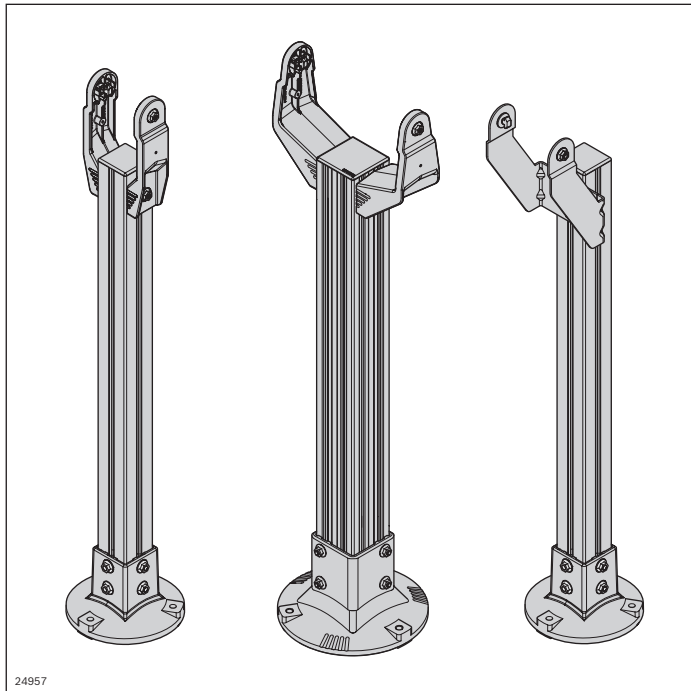



- ▶ Economical conveyor layout for a wide range of applications in the automotive and electronics industries, machine linking, or in the areas of food & packaging and health & care
- ▶ Mounting of sliding rails without rivets or the need to machine the track bearing surfaces
- ▶ Minimal sliding rail interruptions
- ▶ FDA-compliant, low-friction materials for components subject to constant friction
- ▶ Standardized components that can be used universally
- ▶ Continuous product range in the sizes 65, 90, 120, 160, 240, 320

Leg sets AL

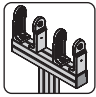

- ▶ Fast, simple leg set adjustment thanks to clever product details
- ▶ Plug-through screws, few screwed connections
- ▶ Easy to clean thanks to ample draining surfaces
- ▶ Simple realization of ascending and descending conveyor sections thanks to a holder with centering lugs that can be broken off
- ▶ Drill guide for simple fastening of drip trays, safety devices, etc.
- ▶ Supports can also be used in conjunction with sections STS

24957

	Leg set 65-120 AL	116
	Curve wheel drive leg set	119
	Leg set 160-320 AL	120
	Supporting bracket AL	122
	Supporting bracket, lateral AL	124

Leg set 65-120 AL

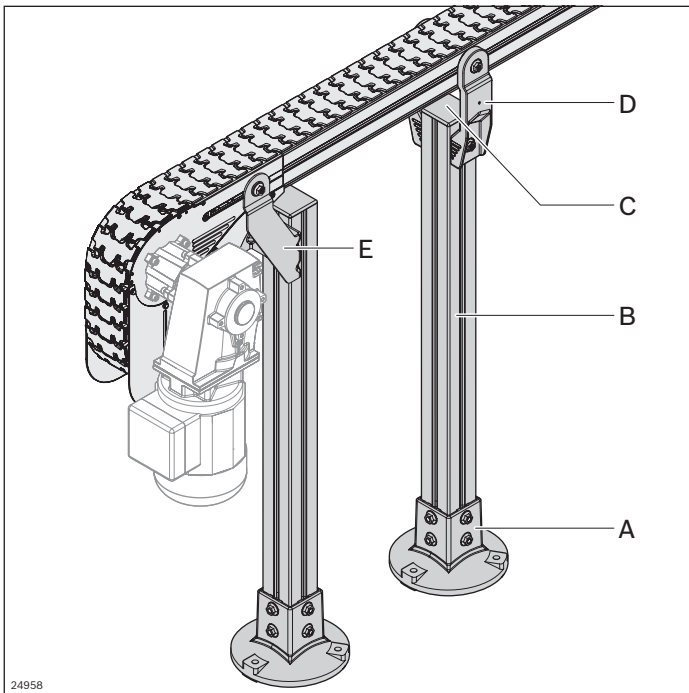

- ▶ Holder is easily centered in the slot thanks to centering lugs (**D**)
- ▶ Very simple assembly with plug-in screwed connection (**D**)
- ▶ Easy-to-clean design with draining surfaces

Optional accessories:

- Dowel, washer, see p. 118

Alternative feet (see MGE catalog, "Feet and wheels" section)

Scope of delivery:

- **A, E:** Including fastening material
- **D:** Set (2 pcs) incl. fastening material

The chain conveyor is placed on the ground by means of supports (and fastened) or even suspended from the ceiling. The suspension is determined by the application. The floor supports for sizes 65, 90 and 120 are constructed from the following single parts:

Foot 60x60 (**A**), strut profile 60x60 (**B**), cover cap (**C**), holder for attaching the section profiles (**D**) 65, 90 or 120. A separate holder (**E**) is used to support the motors / drives.

- Depending on the speed, accumulation behavior and weight, the supports are to be fixed at a distance of approx. 2 ... 3 m
- The leg sets for the stainless steel system (see p. 182) may also be used for the aluminum system
- The holder (**E**) may only be used for AL systems
- The height adjustment range is up to 79 mm (**D**), depending on the return chain, see "Holder adjustment range" p. 118
- The holder (**D**) can also be used for ascending and descending conveyor sections (up to approx. 45°, depending on the return chain) by removing the centering lugs
- Holder (**D**) with drill guide for additional holes to fasten drip trays, trap guards for return chains, etc.

See also setting up the supports for systems ESD, page 202.

Condition on delivery:

- Assembly required

Material:

- **A, D:** Diecast aluminum; silver
- **B:** Aluminum; natural, anodized
- **C:** PA; black
- **E:** Steel; zinc-plated

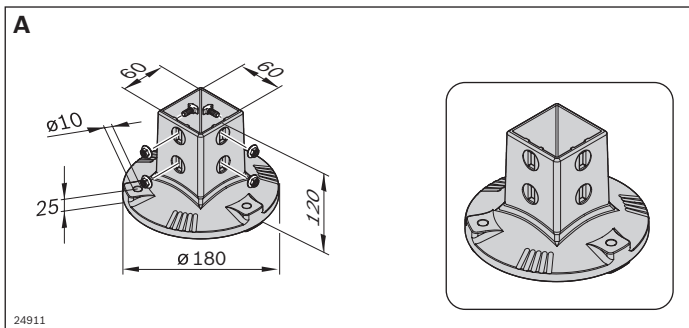

Foot AL		No.
VFplus 60x60	1	3 842 544 875

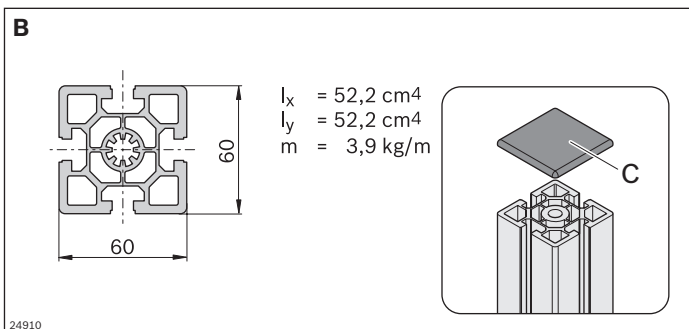

Strut profile AL 60x60	L (mm)	No.
20 pcs	6070	3 842 557 202
1 pc	50 ... 6070	3 842 990 350/L

Cover cap	No.
VFplus 60x60, signal gray	100 3 842 548 810

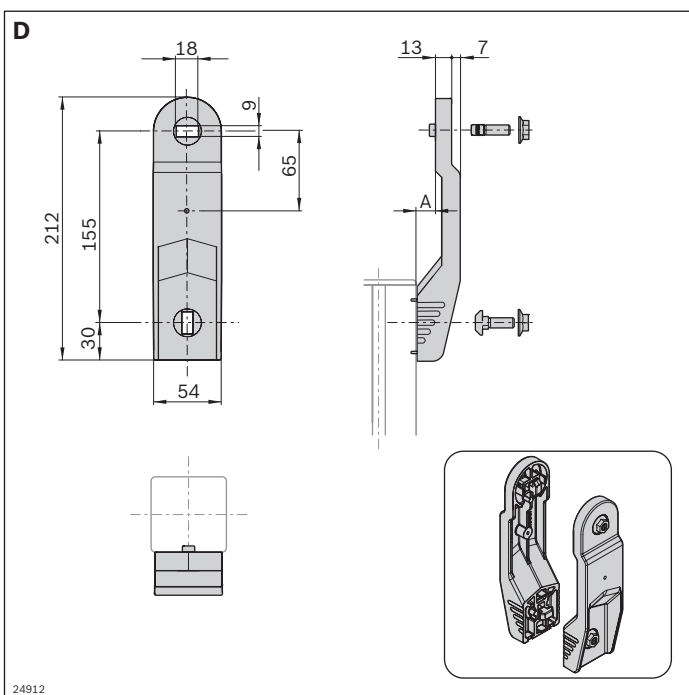

Holder AL	b (mm)	A (mm)	No.
VFplus 65	65	2.5 Set	3 842 546 625
VFplus 90	90	15 Set	3 842 546 626
VFplus 120	120	30 Set	3 842 546 627

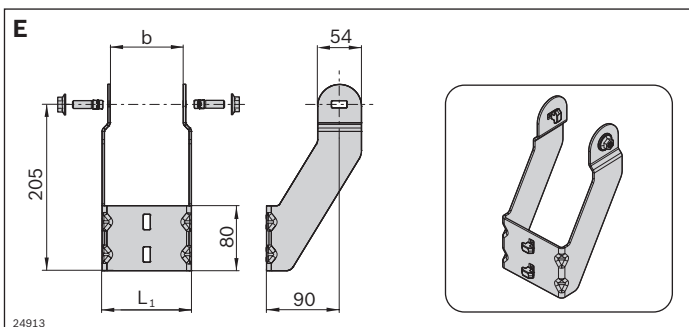

Holder engine support AL	b (mm)	L ₁ (mm)	No.
VFplus 65	65	85 Set	3 842 547 442
VFplus 90	90	110 Set	3 842 547 443
VFplus 120	120	140 Set	3 842 547 444

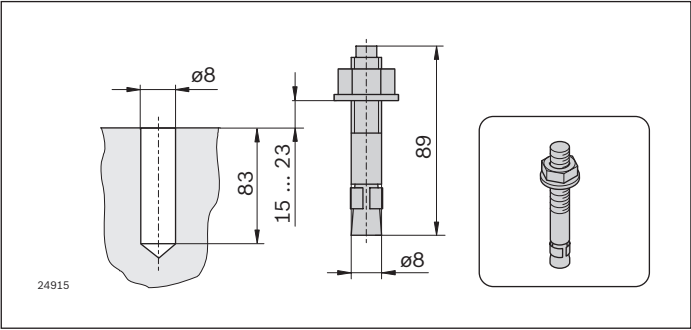

Dowel		No.
	100	3 842 540 668

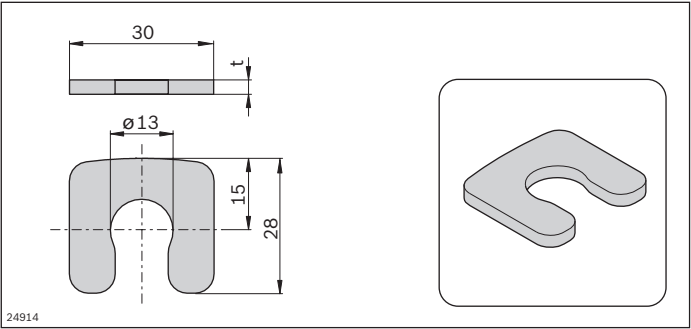

Washer	t (mm)	No.
	1 100	3 842 546 717
	3 20	3 842 546 718

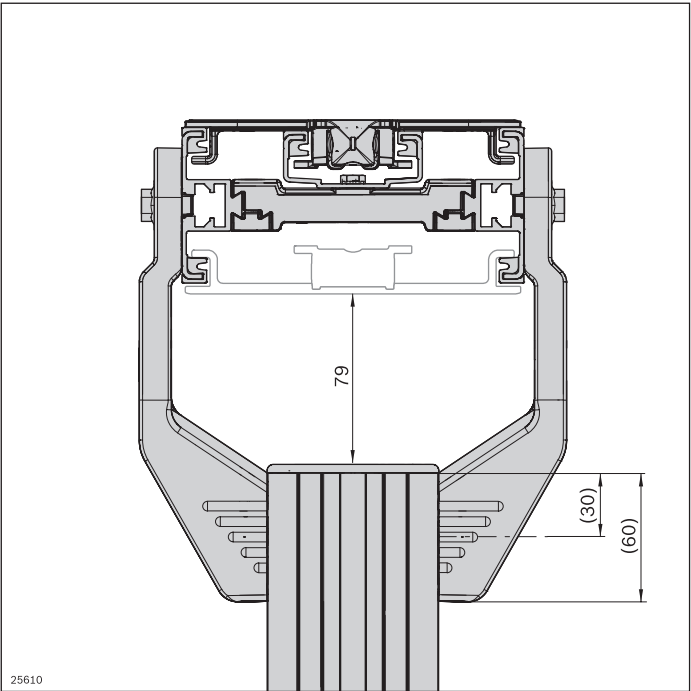

Holder adjustment range

The aluminum holder adjustment range shown relates to the standard installation position (holder flush with the profile end) and the use of a flat chain for horizontal running of the chain. For vertical use, the adjustment range is reduced depending on the angle.

Curve wheel drive leg set



3

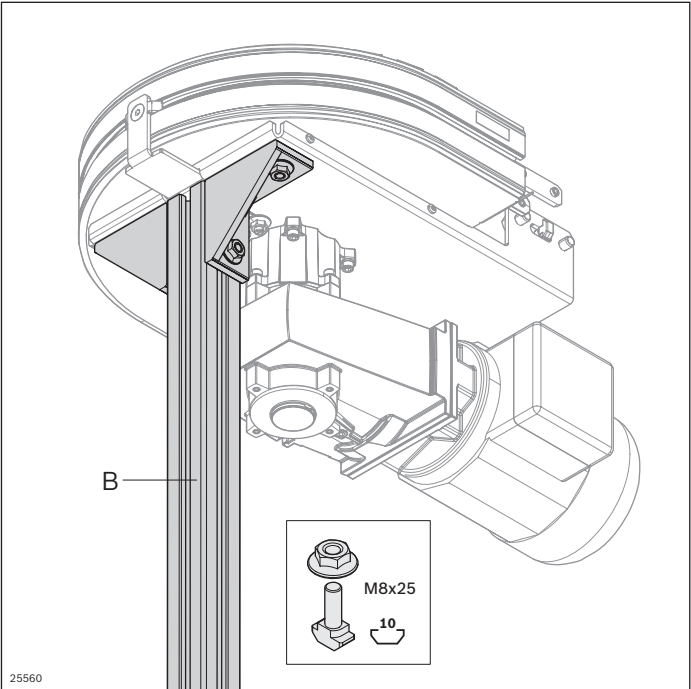

Bracket 40/80	Slot	ESD		No.
Set (standard)	10 / 10		1	3 842 529 386
designLINE set	10 / 10		1	3 842 551 604

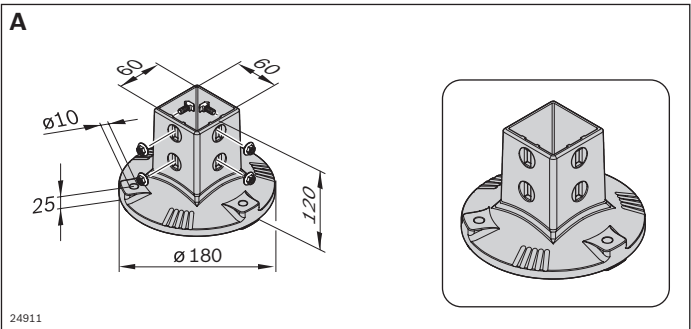

Foot AL		No.
VFplus 60x60	1	3 842 544 875

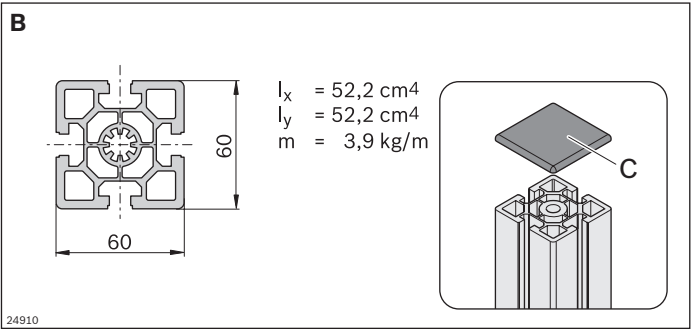

Strut profile AL 60x60	L (mm)	No.
20 pcs	6070	3 842 557 202
1 pc	50 ... 6070	3 842 990 350/L

Cover cap		No.
VFplus 60x60, signal gray	100	3 842 548 810

Leg set 160-320 AL

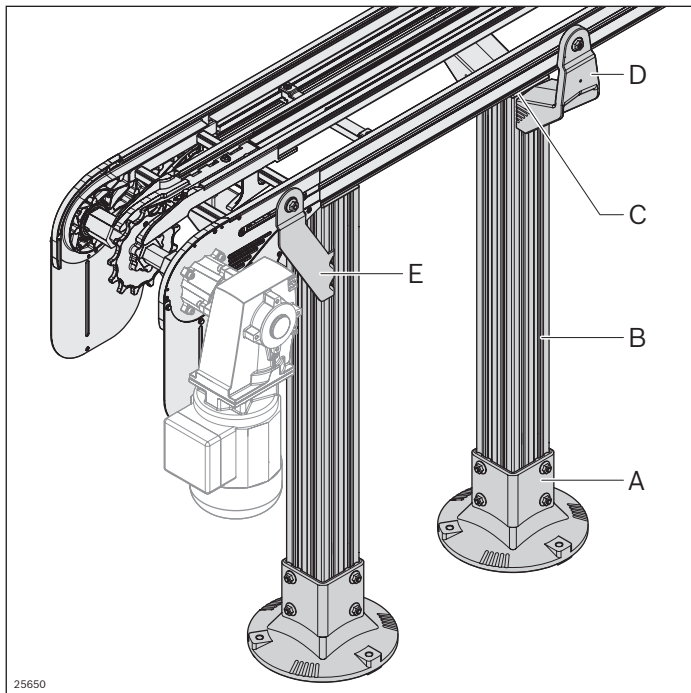

- ▶ Holder is easily centered in the slot thanks to centering lugs (**D**)
- ▶ Very simple assembly with plug-in screwed connection (**D**)
- ▶ Easy-to-clean design with draining surfaces

Optional accessories:

- Dowel, washer, see p. 118

Alternative feet (see MGE catalog, "Feet and wheels" section)

Scope of delivery:

- **A, E:** Including fastening material
- **D:** Set (2 pcs) incl. fastening material

The chain conveyor is placed on the ground by means of supports (and fastened) or even suspended from the ceiling. The suspension is determined by the application. The floor supports for sizes 160, 240 and 320 are constructed from the following individual parts: Foot 80x80 (**A**), strut profile 80x80L (**B**), cover cap (**C**), holder for attaching the section profiles (**D**) 160, 240 or 320.

A separate holder (**E**) is used to support the motors/drives

- Depending on the speed, accumulation behavior and weight, the supports are to be fixed at a distance of approx. 2 ... 3 m
- The leg sets for the stainless steel system (see p. 182) may also be used for the aluminum system
- The holder (**E**) may only be used for AL systems
- The height adjustment range is up to 79 mm (**D**), depending on the return chain, see p. 118
- The holder (**D**) can also be used for ascending and descending conveyor sections (up to approx. 45°, depending on the return chain) by removing the centering lugs
- Holder (**D**) with drill guide for additional holes to fasten drip trays, trap guards for return chains, etc.

Condition on delivery:

- Assembly required

Material:

- **A, D:** Diecast aluminum; silver
- **B:** Aluminum; natural, anodized
- **C:** PA; black
- **E:** Steel; zinc-plated

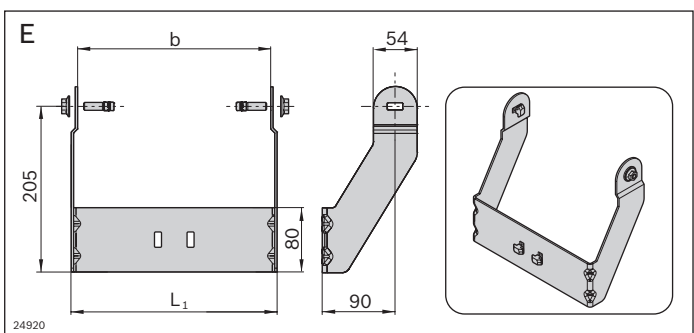
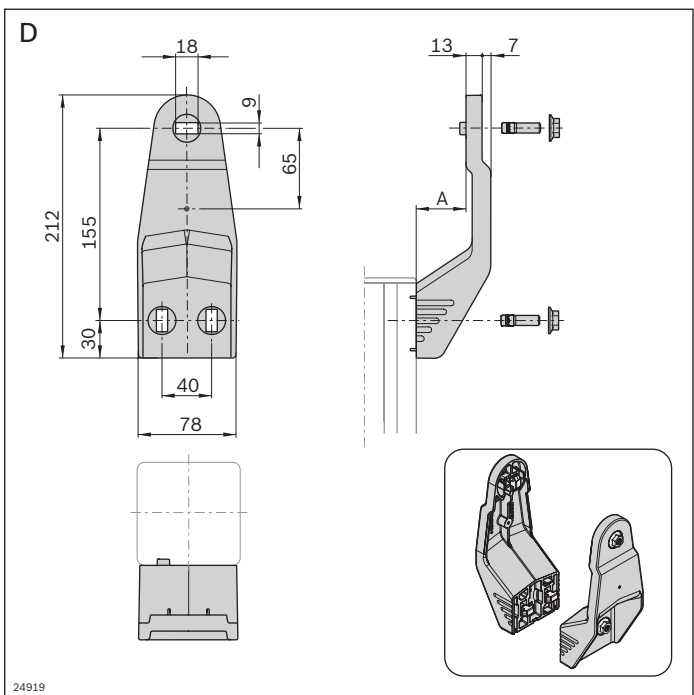
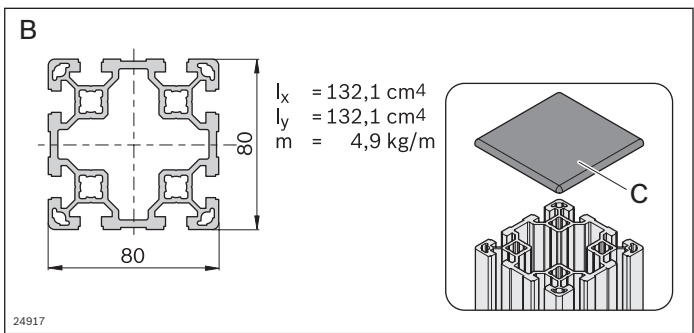
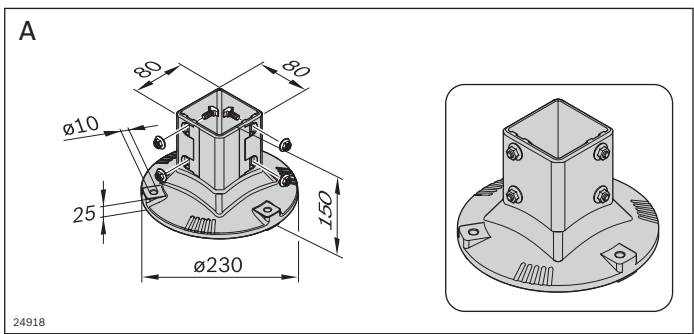

Foot AL	No.
VFplus 80x80	1 3 842 540 173

Strut profile AL 80x80 L	L (mm)	No.
6 pcs	6070	3 842 529 347
1 pc	50 ... 6000	3 842 993 133/L

Cover cap	No.
VFplus 80x80, signal gray	20 3 842 548 750

Holder AL	b (mm)	A (mm)	No.
VFplus 160	160	40	Set 3 842 546 628
VFplus 240	240	80	Set 3 842 546 629
VFplus 320	320	120	Set 3 842 546 630

Holder engine support AL	b (mm)	L ₁ (mm)	No.
VFplus 160	160	180	Set 3 842 547 445
VFplus 240	240	260	Set 3 842 547 446
VFplus 320	320	340	Set 3 842 547 447

Supporting bracket AL

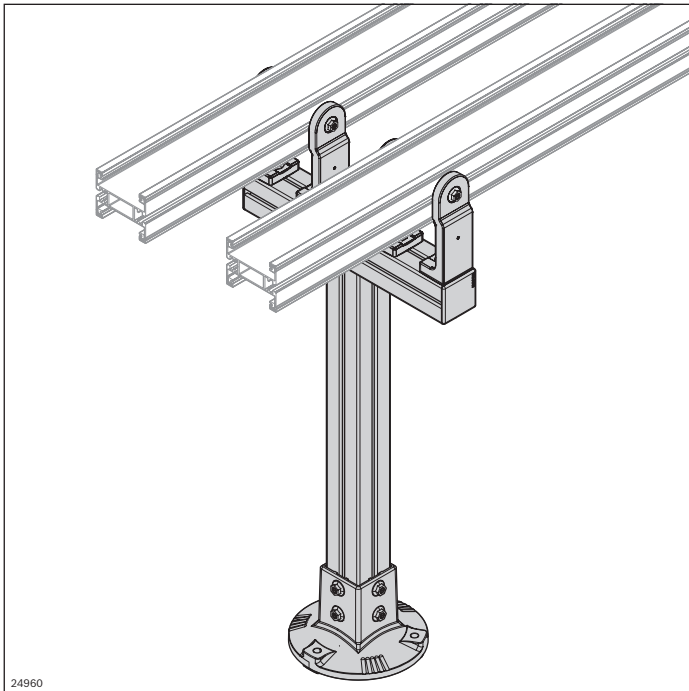

Several parallel sections can be assembled on a horizontal profile with the supporting bracket.

- The distance of the supporting bracket in the conveying direction is approx. 2-3 m, depending on the speed, accumulation behavior and weight
- The supporting brackets can also be used for ascending and descending conveyor sections (up to about 45°, depending on the returning chain) by removing the centering lugs

- ▶ Supporting bracket is easily centered in the slot thanks to centering lugs
- ▶ Very simple assembly thanks to pluggable screwed connection
- ▶ Easy-to-clean design with draining surfaces

Scope of delivery:

- Including fastening material

Material:

- Diecast aluminum; silver

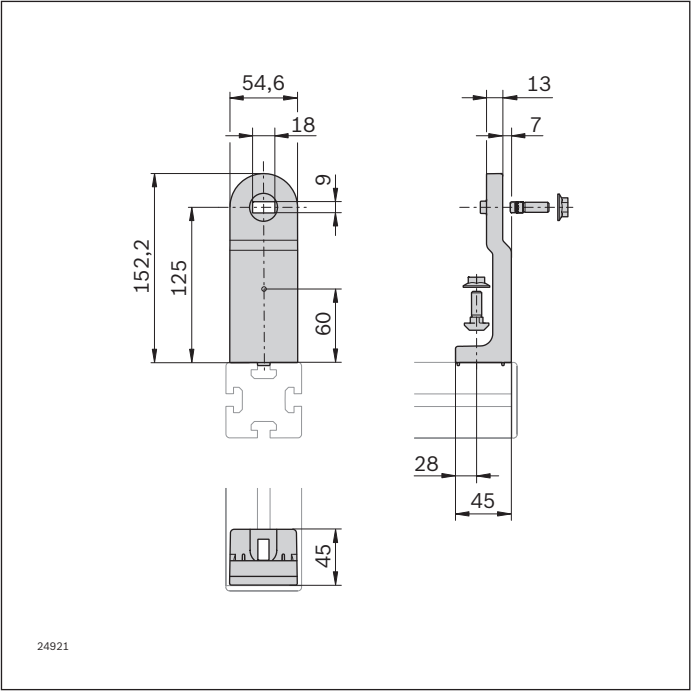

Supporting bracket VFplus AL		No.
Set		3 842 546 632

Supporting bracket, lateral AL

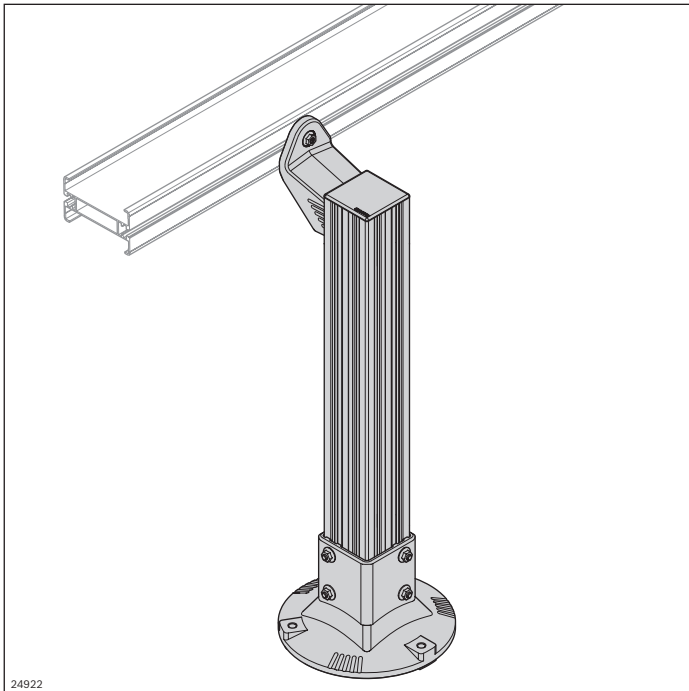

The lateral supporting bracket is for mounting on a vertical strut profile 80x80. It is suitable for the construction of an alpine conveyor, for example.

- In the case of one-sided attachment, the lateral supporting bracket is only permitted for sizes up to 120
- The lateral supporting bracket can also be used for ascending and descending conveyor sections (up to approx. 45°) by removing the centering lugs

- Supporting bracket is easily centered in the slot thanks to centering lugs
- Very simple assembly thanks to pluggable screwed connection

- Easy-to-clean design with draining surfaces

Scope of delivery:

- Including fastening material

Material:

- Diecast aluminum; silver

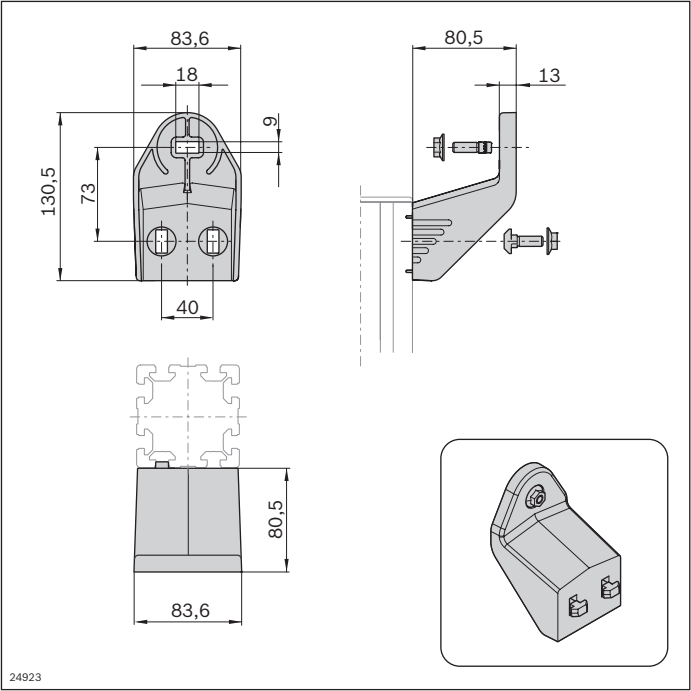

Supporting bracket	
VFplus lateral AL	 No.
Set 3 842 547 461	