

Stainless steel system (STS)

VarioFlow *plus*

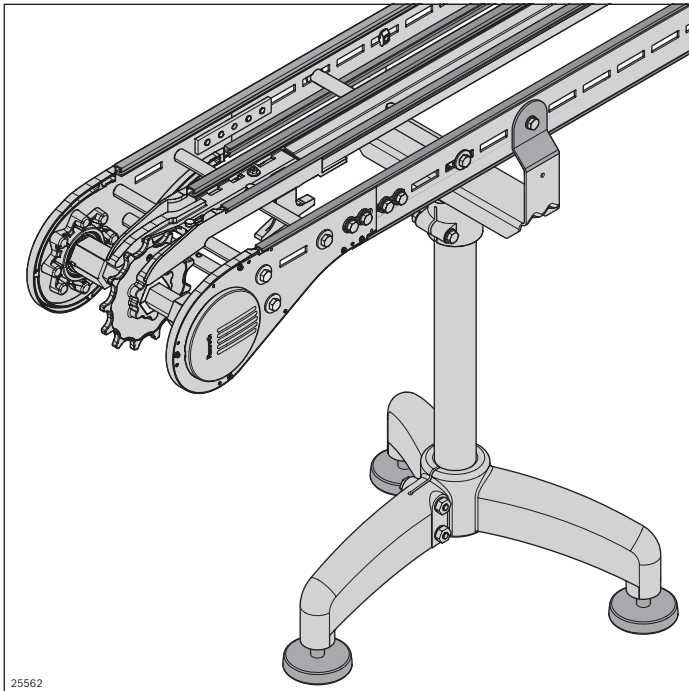

- ▶ FDA-compliant materials and easy-to-clean surfaces fulfill the high standards in the areas of the food & packaging and health & care industries where hygiene is crucial
- ▶ Mounting of sliding rails without rivets or the need to machine the track bearing surfaces
- ▶ Minimal sliding rail interruptions
- ▶ FDA-compliant, low-friction materials for components subject to constant friction
- ▶ Standardized components that can be used universally
- ▶ Continuous product range in the sizes 65, 90, 120, 160, 240, 320

25562

Sections STS

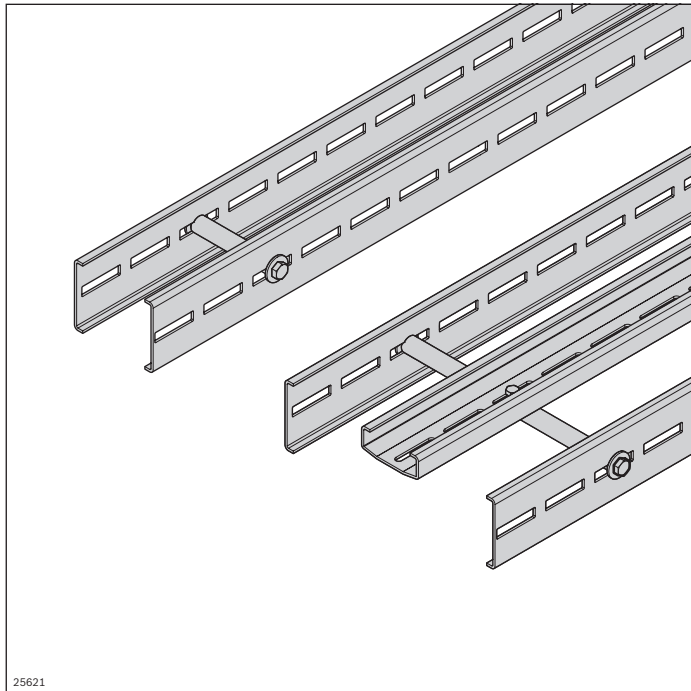

- ▶ Easy-to-clean sections due to largely media-resistant components
- ▶ Mounting of sliding rails without rivets or the need to machine the track bearing surfaces
- ▶ Sliding rails with optimized anti-friction properties and FDA-compliant materials
- ▶ One sliding rail cross-section for all sizes
- ▶ Few screwed connections
- ▶ One profile cross-section for all sizes
- ▶ Use of a support profile from size 160

	Section profile STS open	130
	Section profile STS Clean	132
	Sliding rail	134
	Steel sliding rail	136
	Profile connector STS	138
	Assembly module STS	139

Section profile STS open

Cross connector STS

Support profile STS

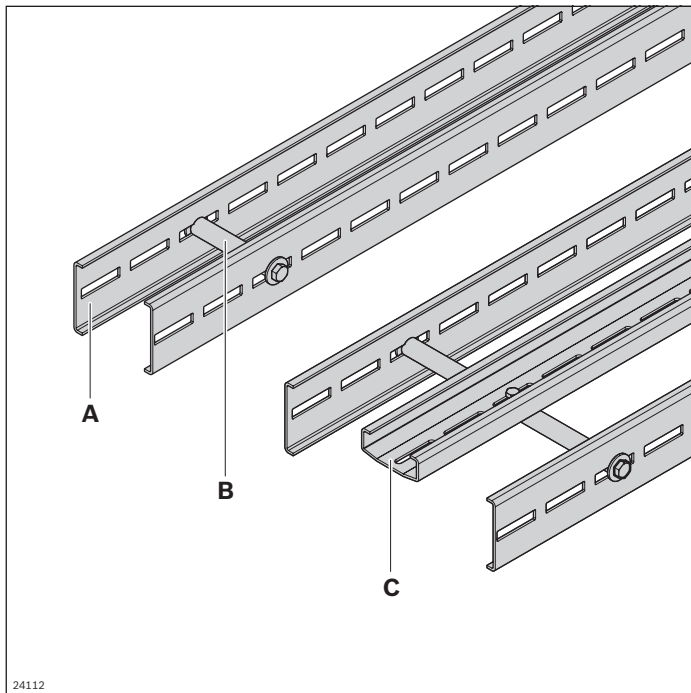

The open construction of the section profile **(A)** allows dirt or foreign particles to be removed directly. To build a conveyor section, 2 open section profiles are required, which are connected by cross connectors. A support profile is necessary for sizes 160 and up.

- Same profile cross-section across all sizes (65-320)

The cross connector **(B)** is the connection of two profile halves to make an open section profile. The size is determined by using cross connectors of different lengths.

From size 160, a support profile **(C)** is required. The support profile is attached to the existing cross connectors.

Open section profile STS (A)

- ▶ Elongated holes for attaching a drive/return unit, curves, lateral guides, leg sets, or other accessories
- ▶ Simple to clean

Cross connector STS (B)

- ▶ Cross connector with mounting option for support profile

Required accessories:

- **A:** Sliding rail, see p. 134; profile connector, see p. 138; cross connector, see p. 130; support profile from size 160, see p. 130

Scope of delivery:

- **B:** Including fastening material

Support profile STS (C)

- ▶ With elongated holes for fastening in regular intervals
- ▶ Plug-through stainless steel T-nuts as mounting option on the section profile

Material:

- **A, B, C:** Non-rusting steel 1.4301

Condition on delivery:

- **A, B:** Assembly required

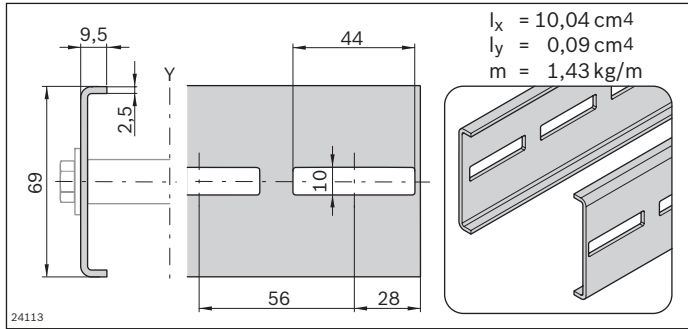

Section profile VFplus STS open	L (mm)	No.
12 pcs	3024	3 842 546 649
2 pcs	3024	3 842 547 905
1 pc	75 ... 3000	3 842 996 027/L

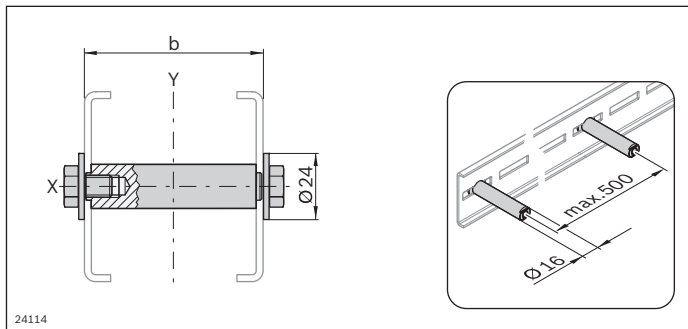

Cross connector STS	b (mm)	No.
VFplus 65 STS	65	10 3 842 546 684
VFplus 90 STS	90	10 3 842 546 685
VFplus 120 STS	120	10 3 842 546 686
VFplus 160 STS	160	10 3 842 546 687
VFplus 240 STS	240	10 3 842 546 688
VFplus 320 STS	320	10 3 842 546 689

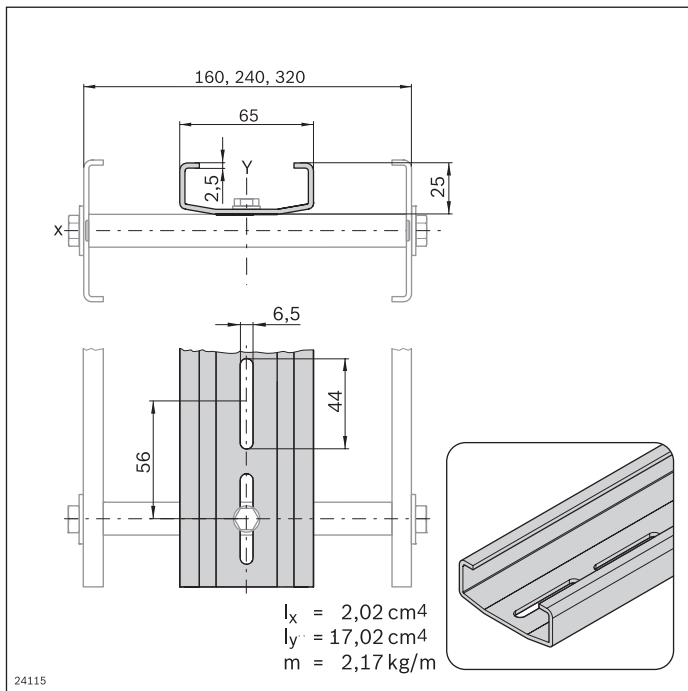

Support profile VFplus STS	L (mm)	No.
12 pcs	3024	3 842 546 700
1 pc	3024	3 842 547 906
1 pc	75 ... 3000	3 842 996 029/L

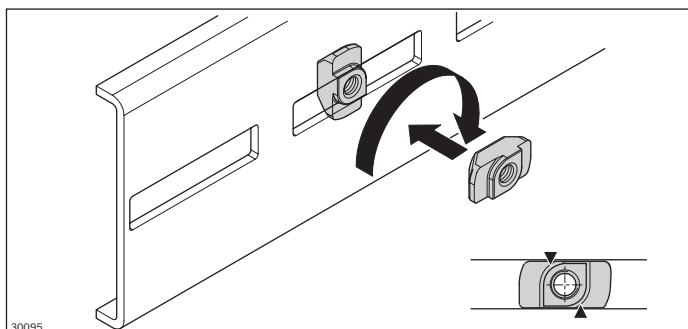

Standard element for the secure connection of accessory parts to the section profile

Notice: T-nuts MGE do not fit in the section profile STS.

T-nut	No.
VFplus STS M6	20 3 842 546 706
VFplus STS M8	20 3 842 546 707

Section profile STS Clean

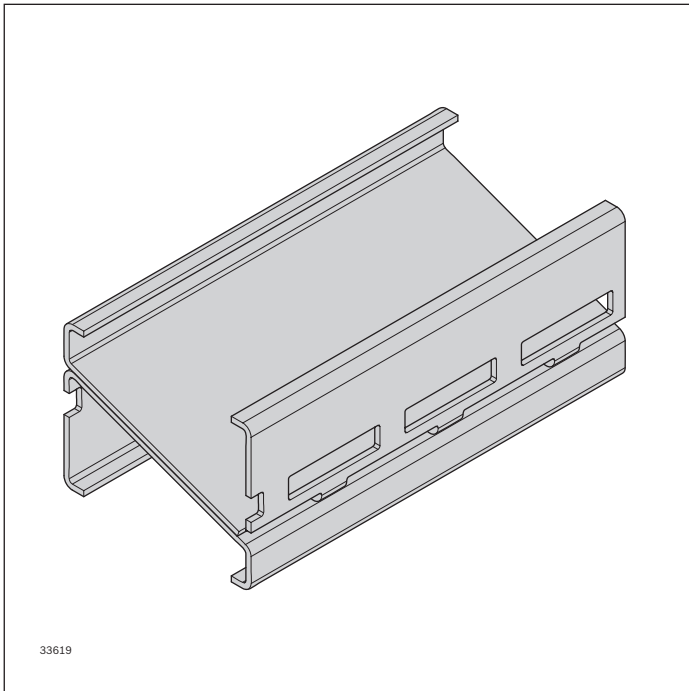

The construction of the section profile STS Clean allows for the direct discharge of dirt or foreign particles without them reaching the returning chain.

- Size: 90
- For use in harsh production environments

Notice: Not compatible with the system AL.

- Elongated holes for attaching a drive/return unit, curves, lateral guides, supports and other accessories
- Simple to clean

Required accessories:

- Profile connector STS Clean Section, see p. 133
- Sliding rail, see p. 134

Optional accessories:

- T-nut VF*plus* STS, see p. 131

Material:

- Non-rusting steel 1.4301

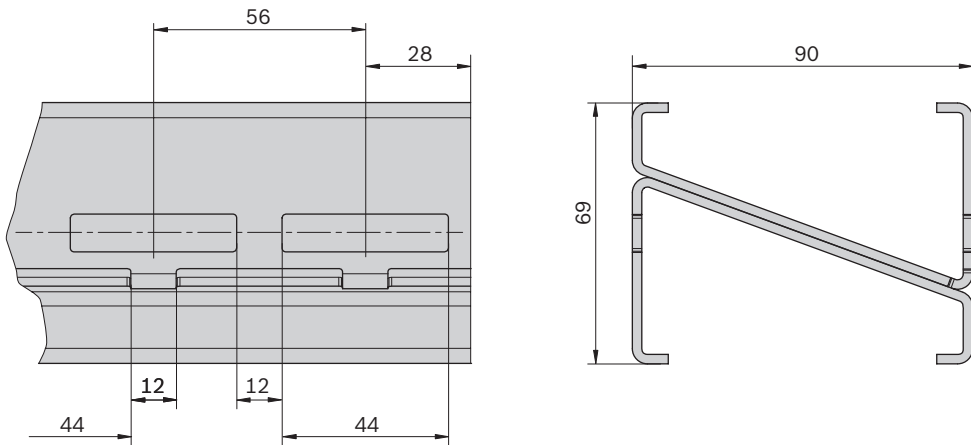

33620

Section profile STS Clean	L (mm)		No.
	3024	1	3 842 553 006
	75 ... 3000	1	3 842 996 314

Profile connector STS Clean Section	H (mm)		No.
	17	10	3 842 552 927

Notice: When using the section profile STS Clean with the basic units (head drive, return unit, connection drive) the enclosed profile connector (H = 20 mm) must be replaced with the profile connector STS Clean Section (H = 17 mm) 3 842 552 927.

Sliding rail

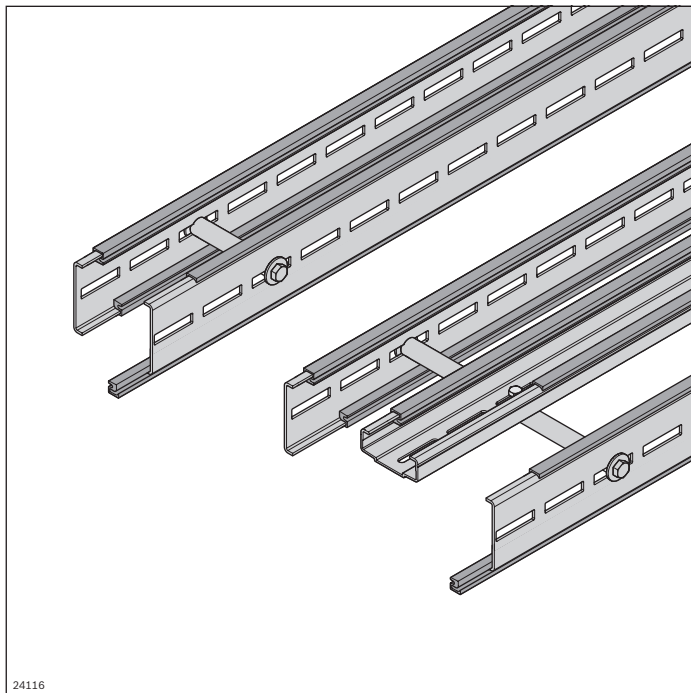

- ▶ Easy assembly – simply clip onto the section profile
- ▶ Secured against axial shifting with lateral screw fittings
- ▶ Gliding surface machining: Not required
- ▶ Material
 - with sliding rail Premium, Advanced: FDA CFR 21
 - with sliding rail Basic: EU 10/2011, FDA CFR 21
- ▶ One cross-section for all section profiles AL and STS

Required accessories:

- Sliding rail assembly tool, see p. 288
- Oval-head screw 2.9x9.5 DIN 7981; DIN EN ISO 7049
see p. 135
1 screw for each sliding rail section

Material:

- PE-UHMW

The sliding rail is clipped into the section profile and guides the conveyor chain.

Lateral securing means the sliding surface does not need to be machined. Wear and noise level are thus reduced to a minimum.

Three sliding rails with different main areas of application are available:



- Basic: Straight sections and curve wheels, v_{\max} 60 m/min
- Advanced: Sections with sliding curves, v_{\max} 60 m/min, clean room
- Premium: Sections with sliding curves, v_{\max} 100 m/min, clean room

For the selection of sliding rails, see the "Technical data" chapter on page 300. See also sliding rails ESD on page 192 and steel sliding rail on page 136.

Extend the sliding rail over the component interfaces to ensure minimum wear and noise emissions. Interruptions to the profile or component connection must be avoided. If an interruption is necessary after 10 m, the sliding rail must be attached laterally with a sheet metal screw (**A**).

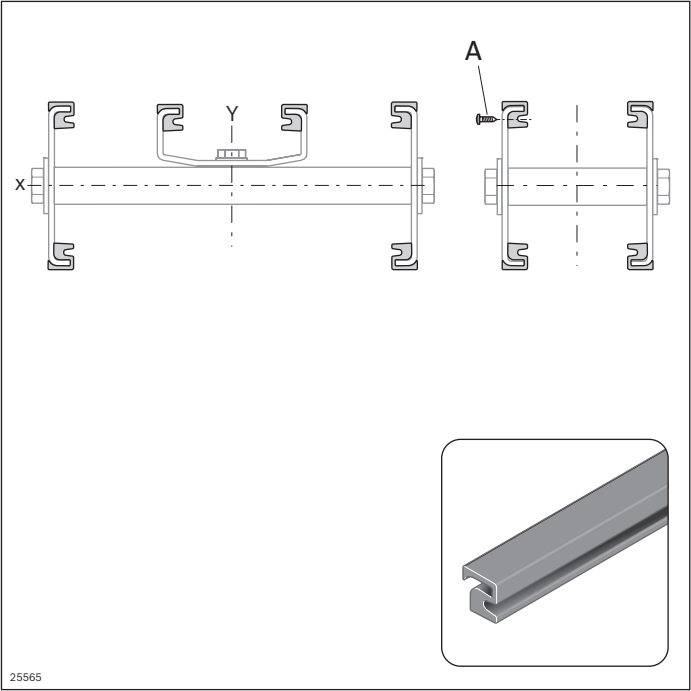
Notice: After the sliding curves, an interruption is provided as an expansion joint in the inner curve area.



Sliding rail VFplus	Color	L (mm)		No.
Premium	gray	30000	1	3 842 546 116
Advanced	white	30000	1	3 842 549 727
Basic	blue	30000	1	3 842 549 730
See also sliding rail ESD, see p. 192 and steel sliding rail, see p. 136.				
Oval-head screw				No.
A			100	3 842 533 915

Steel sliding rail

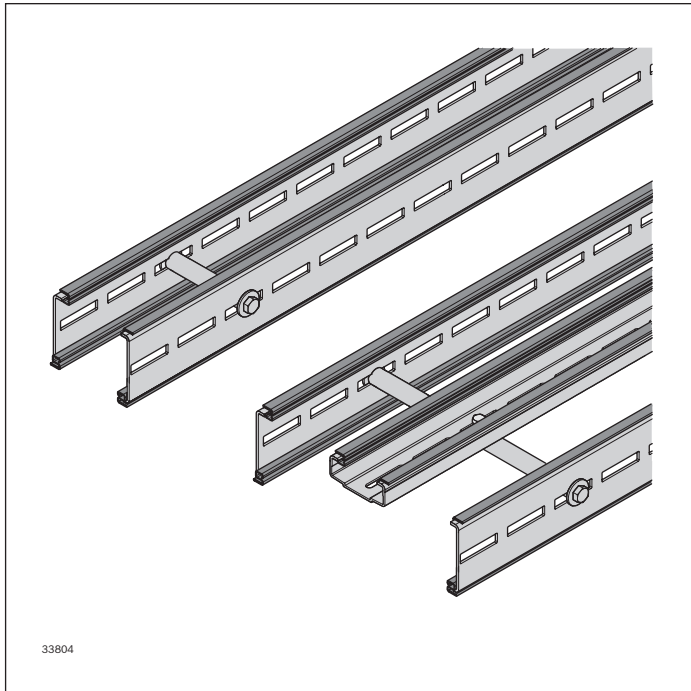

- ▶ Easy assembly – simply clip onto the section profile
- ▶ Secured against axial shifting via lateral fixing
- ▶ Gliding surface machining: Not required
- ▶ One cross-section for all section profiles AL and STS

Required accessories:

- Pop rivet D3x8 mm, see p. 137
- Number of rivets:
 - Straight sliding rail section: 1 rivet
 - 30°/45° curves: 2 rivets
 - 90° curve: 3 rivets
 - 180° curve: 6 rivets

Material:

- Non-rusting steel 1.4301

The steel sliding rail is suitable for use in abrasive ambient conditions (reduced service life of the conveyor chain). It is clipped in to the section profile and fixed in place at the side via a pop rivet. The side fixing reduces the friction and the noise level to a minimum. The steel sliding rail butt joints are merely chamfered. The Advanced sliding rail is used in the lower run of the curve wheels.

- Steel sliding rail straight section (**A**), not bendable
- Steel sliding rail curve wheels (**B**) 30°, 45°, 90°, 180°
- Dry, wet and abrasive environment
- Size:
 - Straight section: All track widths
 - Curve wheel 65, 90, 120
- Not suitable for use in horizontal sliding curves
- Only sliding rails Advanced or Premium can be used in vertical curves

For the selection of sliding rails, see the "Technical data" chapter on page 300.

Notice: Ensure gap-free assembly (without expansion joint), as foreign bodies could otherwise get trapped in the gap and damage the chain.

Notice: Non-destructive dismantling of the steel sliding rail is not possible. A target separation point of the system must therefore be defined before assembly. Overlap the steel sliding rail by 10 ... 15 mm on the section profile separation point. This ensures that it is still possible to pull apart the two parts.

Extend the steel sliding rail over the component interfaces to ensure minimum wear and reduced noise emissions. Interruptions directly on the profile or component connection must be avoided.

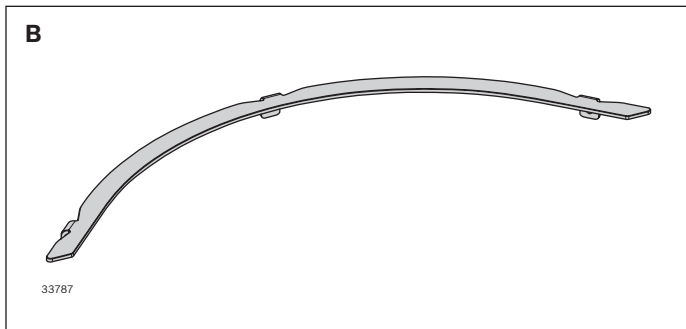
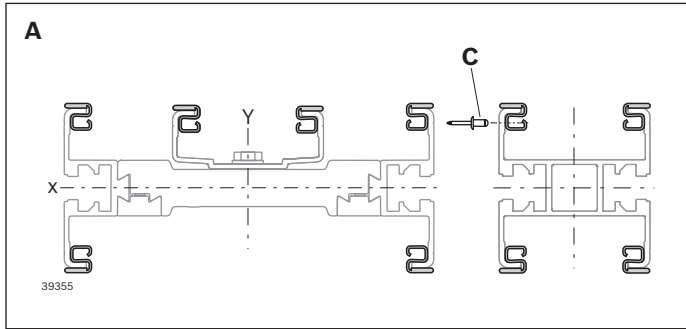

Sliding rail VFplus Steel	L (mm)	No.
A Straight section	3000	1 3 842 552 970

Pop rivet D3x8mm	No.
C	100 3 842 557 004

Steel sliding rail; curve wheel VFplus 65	No.
B Steel 30°	1 3 842 557 030
B Steel 45°	1 3 842 557 031
B Steel 90°	1 3 842 552 972
B Steel 180°	1 3 842 552 973

Steel sliding rail; curve wheel VFplus 90	No.
B Steel 30°	1 3 842 557 032
B Steel 45°	1 3 842 557 033
B Steel 90°	1 3 842 552 974
B Steel 180°	1 3 842 552 975

Steel sliding rail; curve wheel VFplus 120	No.
B Steel 30°	1 3 842 557 034
B Steel 45°	1 3 842 557 035
B Steel 90°	1 3 842 557 036
B Steel 180°	1 3 842 557 037

Pop rivet D3x8mm	No.
C	100 3 842 557 004

Profile connector STS

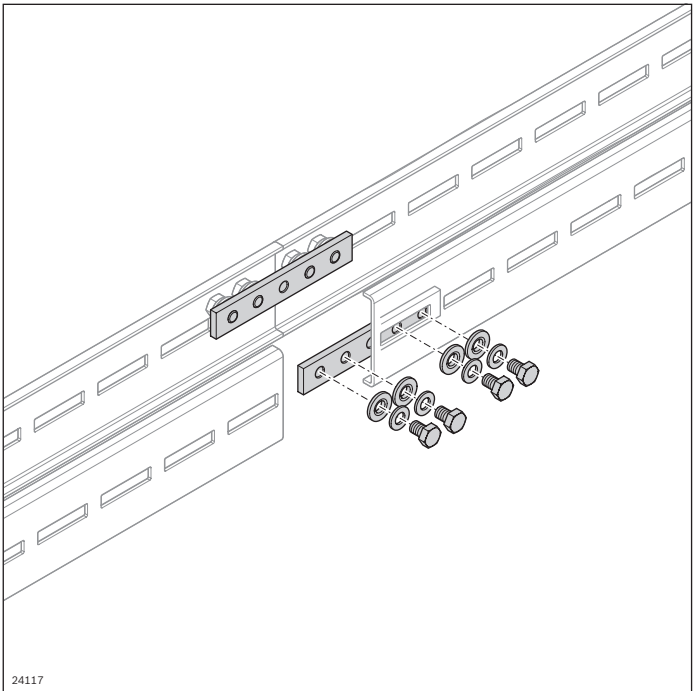

Two profile connectors are used to connect the end faces of the section profiles.

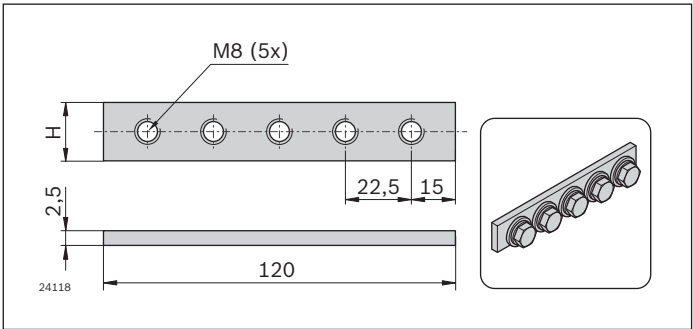

Profile connector VF <i>plus</i> STS	H (mm)		No.
	20	10	3 842 547 895

Profile connector STS Clean Section	H (mm)		No.
	17	10	3 842 552 927

Scope of delivery:

- Complete

Material:

- Non-rusting steel 1.4301

Scope of delivery:

- Assembly required

Assembly module STS



4

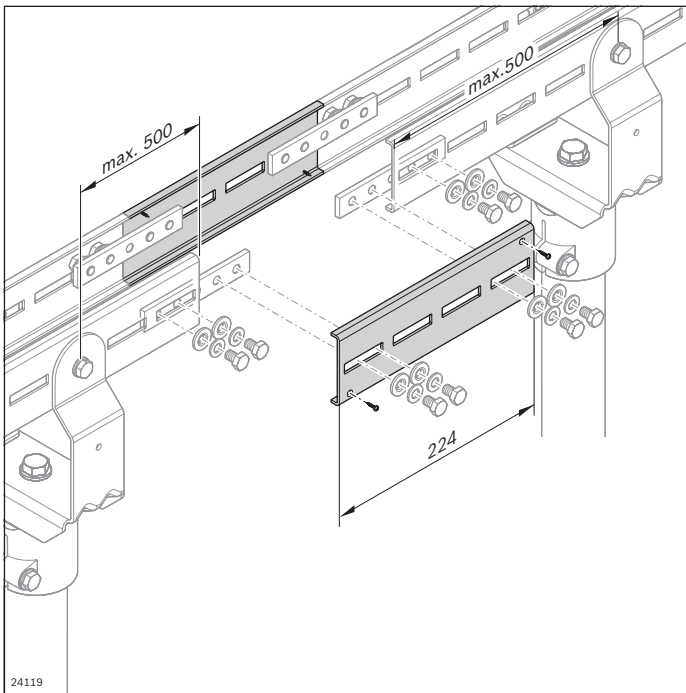

The assembly module is used for inserting and closing or opening the chain. It can be installed at any point on the conveyor section that is easy to access in operation. The assembly module is intended for sections with drives without a chain bag (e.g. wedge conveyor).

- Max. distance from the nearest leg sets on both sides is 500 mm
- The support profile with sliding rail is not interrupted in the assembly module to increase the smooth running
- Sliding rail interruption is only required on the side to be opened

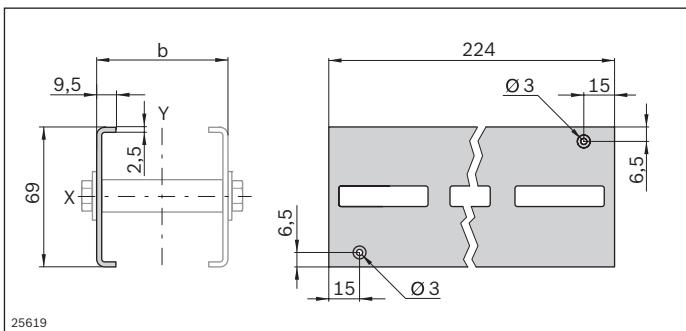

	L (mm)	No.
Assembly module VFplus STS	1	3 842 547 900
Sliding rail VFplus Premium	30000	1 3 842 546 116
Sliding rail VFplus Advanced	30000	1 3 842 549 727
Sliding rail VFplus Basic	30000	1 3 842 549 730
Sliding rail VFplus Steel	3000	1 3 842 552 970
Sliding rail VFplus ESD	30000	1 3 842 557 000

Required accessories:

- Sliding rail, see p. 134, 136, 192

Scope of delivery:

- Including 4 profile connectors and sheet-metal screws for fastening the sliding rail

Condition on delivery:

- In single parts

Material:

- Non-rusting steel 1.4301